

PL V 11.5W BYP TITANIUM LED SERIES



11.5W REPLACES



26W CFL

60% Energy Savings

PRO



- Ⓞ **HYBrid installation - DIrect or BYPass**
- Ⓞ **Compatible with magnetic ballasts - DIrect installation**
- Ⓞ **Built-in universal voltage driver - Bypass installation**
- Ⓞ **Compatible with G24d, GX24d, G24q & GX24q bases**
- Ⓞ **Innovative round design**
- Ⓞ **Exceptional efficacy 89 LPW**



PL PRODUCT FEATURES

BYPass Installation - Electronic Ballasts

This PL V lamp is not compatible with electronic ballasts and requires bypassing the ballast during installation. The lamp runs directly off line voltage to eliminate compatibility problems, incidental power loss, lifetime issues, and maintenance costs associated with ballasts.

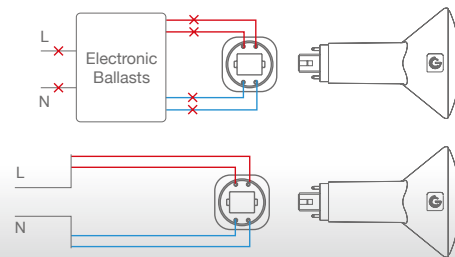

HYBrid Installation - DIrect or BYPass - Magnetic Ballasts

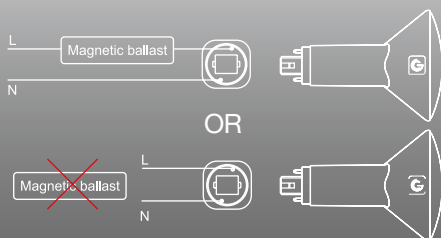

When used with a magnetic ballast, the PL V can function as a plug & play lamp and operate with the existing ballast. If the ballast is not compatible, it can be bypassed and the lamp can run directly off line voltage.

PL V 11.5W BYP TITANIUM LED SERIES



APPLICATIONS

Retail



Hospitality



Office



Ref.#: DS153-PLV-11.5W-BYP

- Base:** G24d, GX24d, G24q & GX24q (2/4-pin CFL)
- Voltage:** Magnetic ballast compatible 120-277V
- Dimmable:** No
- PF:** 0.9
- Lifetime:** 50,000 hrs
- Weight:** 0.21lb / 95g

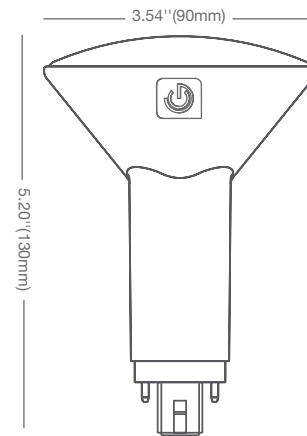

SPECIFICATIONS*

Model	Product	Power (W)	CCT	CRI (typ.)	Lumens	LPW	Beam Angle
11.5PLV/827/BYP	57921	11.5	Soft White 2700K	80	950	83	120°
11.5PLV/830/BYP	57922	11.5	Warm White 3000K	80	1000	87	120°
11.5PLV/835/BYP	57923	11.5	Neutral White 3500K	80	1000	87	120°
11.5PLV/840/BYP	57924	11.5	Cool White 4000K	80	1020	89	120°

* Specification data is preliminary and subject to change
 ** Suitable for damp locations. Not for use where directly exposed to weather or water
 *** Not intended for use in enclosed fixtures
 **** Full installation guide and more details available on website